

## 3 Megapixel Day & Night Vandal Dome Network Camera

VD-300Ap V5

HDTV 1080p/720p • 3M/2M/1.3M Resolution Supported



- 3 Megapixel High Resolution Outdoor Vandal Dome Camera
- **SmartFocus**® to Ease the Zoom and Focus Adjustment Remotely
- HDTV Quality (Full HD 1080p @ 30fps Streaming)
- MPEG-4, MJPEG and H.264 Triple Codec Compression
- **Intelligent Multi-Profile Sensor Management**® for Different Environments
- Removable IR-cut Filter /Auto Light Sensor for Day and Night
- 1 DI/DO for External Alarm and Sensor Device
- 3 Axis design
- Two-way Audio/Built-in SD/SDHC/SDXC Memory Card Slot for Local Storage
- IK10 Vandal Proof and IP67 Weather Proof Outdoor Enclosure
- Power over Ethernet/DC 12V/AC 24V support
- Smart IR to adjust the IR LED light across the entire area to get a well illuminated image



### Photo Indication & Dimension Diagram

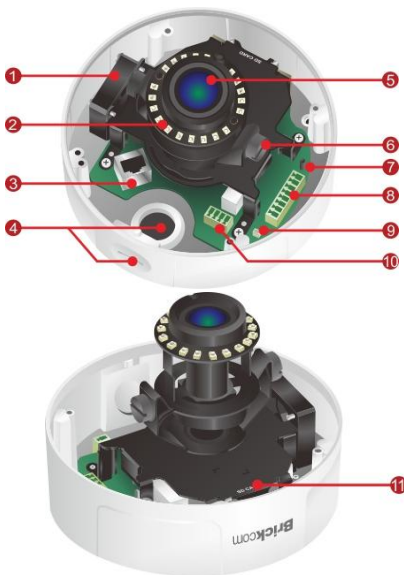

- |   |   |
|---|---|
| <ul style="list-style-type: none"> <li>① Fan</li> <li>② LEDs</li> <li>③ RJ45 Connector<br/>(For Ethernet and 802.3 at PoE Plus)</li> <li>④ Conduit Plug and Hole</li> <li>⑤ LENS</li> <li>⑥ Tilt Screw</li> <li>⑦ Reset Button</li> </ul> | <ul style="list-style-type: none"> <li>⑧ Terminal Block<br/>(For Audio in/out, DIDO)</li> <li>⑨ TV Out Connector</li> <li>⑩ Terminal Block (For DC12V/AC24V)</li> <li>⑪ SD Card Slot</li> </ul> |
|---|---|

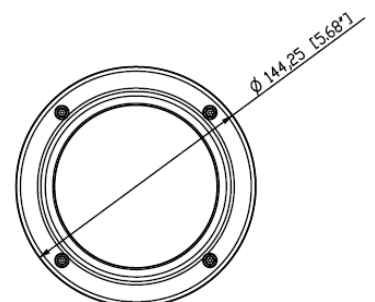
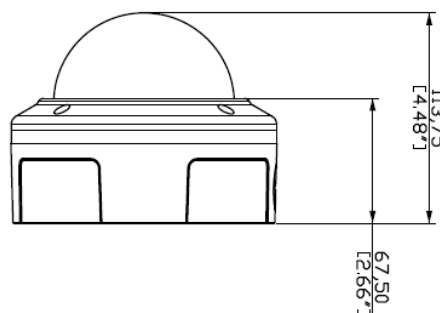

Camera		Events and Alarm Management	
<b>Models</b>	3M, Motorized Lens, SmartFocus®	<b>Events</b>	Motion Detection/ Schedule/ Audio Detection/ Digital Input/ Temperature Alarm/ Auto Focus Shift for Day & Night
<b>Hardware System</b>	CPU: 533 MHz Flash: 32M RAM: 256M DDR	<b>Alarm</b>	Stream/Snapshot to FTP/Email/Samba/SD-Card HTTP/Email Notification/ Digital Output
<b>Image Sensor</b>	Sensor Type : 1/2.5" CMOS Sensor Sensor Resolution :2048x1536 pixel	<b>Audio</b>	
<b>Minimum Illumination</b>	0 lux (IR ON, B/W) 0.01lux (IR OFF, B/W) 0.02 lux (F1.4, Color)	<b>Audio Streaming</b>	2-way Audio Support
<b>IR Illuminators</b>	Built -in IR Illuminators, effective up to 25 meters IR LED: 20pcs IR wavelength: 850nm	<b>Audio Compression</b>	G.711, AMR (8 kHz, Mono, PCM)
<b>Lens</b>	Lens Type: Board Lens F No.: 1.4 Focal Length: f= 3.3mm(W)~10.5mm(T) View Angle(Normal Mode): (H): 70°~26°/ (V): 51°~20°/ (D):88°~32° View Angle(Ultra Wide Mode): (H): 107°~33°/ (V): 77°~22°/ (D):114°~41°	<b>Audio Input/ Output</b>	Line In/ Out
<b>Day &amp; Night ICR</b>	Triggered by Light sensor, Scheduling, Digital Input	<b>General</b>	
<b>Local Storage</b>	Built-in SD/SDHC/SDXC Max.64G Memory Card Slot	<b>Communication</b>	Ethernet : one 10/100Mbps RJ-45 Supported Protocols : TCP/IP, UDP, ICMP, DHCP, NTP, DNS, DDNS, SMTP, FTP, HTTP, Samba, PPPoE, UPnP, RTP, RTSP, RTCP, IPv6
<b>Video</b>		<b>Power Input/ Operating Temperature</b>	802.3 af POE/ DC12V 1A /AC 24V: -20°C ~ 60°C (-4°F ~140°F) 802.3at PoE Plus(build in fan and heater): -40°C ~ 60°C (-40°F ~140°F)
<b>Compression Streaming</b>	H.264 / MPEG4 / MJPEG Simultaneous multiple streams	<b>Max. Power Consumption</b>	DC12V 1.5A/AC 24V: 12.5 Watts 802.3 af POE:15 Watts 802.3 at POE Plus:27.5 Watts
<b>Video Setting</b>	Multi-Profile Image Management: Day/ Night/ Sunset/ User 1/ User 2 Auto Exposure Control Manual Exposure Control: 1/20000~1/5s Manual Gain Control: 1X ~ 32X Manual White Balance Control: 2000K~7000K	<b>Environment</b>	Water Proof: IP67 Operating Humidity : 10% ~ 80%
<b>S/N Ratio</b>	38.1 dB	<b>Dimension</b>	113.75 (D) mm X 144.25(H) mm
<b>Image Resolution</b>	<b>3M</b> : 2048x1536 @ 18fps <b>2M (Full HD)</b> : 1920x1080 @30fps <b>1M</b> : 1280x720 @ 30fps	<b>Weight</b>	860g/1.90lb
		<b>Housing</b>	Weather-proof (IP67) Vandal-proof (IK10)
		<b>Certification</b>	FCC, CE, IK10
		<b>Viewing System Requirements</b>	OS: Microsoft Windows 8/7/Vista/XP/2000 Browser: Mozilla Firefox, Internet Explorer 7/8 or above, Safari, Google Chrome Cell Phone: 3GPP player Real Player: 10.5 or above Quick Time: 6.6 or above VLC
		<b>Warranty</b>	Limited 2-year warranty

## Work Best With

### Camera Accessories Options



**L-WM-01**  
Camera Bracket



**POE30U \***  
High Power PoE Injector



**WPC \***  
Waterproof Connector

### Network Equipment Options



**PS-588I-v2**  
8-port 10/100M PoE Fast Ethernet Switch



**PS-7242IL-AT**  
24-port 10/ 100M High Power PoE+ Web Smart Ethernet Switch