

Audio Discriminator

ENFORCER 190 Coverage: 45ft (14m) Front, 25ft (8m) Each Side

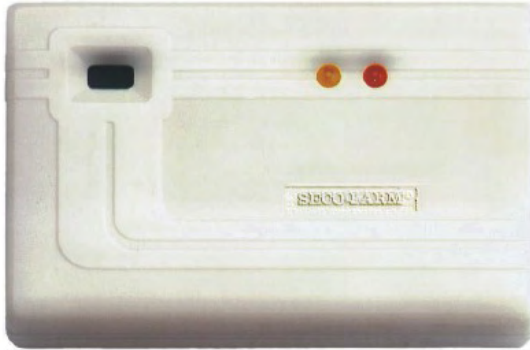

- Eliminates the need for unsightly individual detectors on each pane of glass.
- Protects all windows and glass doors within a 25ft (8m) radius.
- When mounted on a wall, covers an area 45ft (14m) to the front and 25ft (8m) to either side of the unit.
- For larger areas, two or more units can be used without fear of interfering with each other.
- Equipped with an N.C. tamper circuit to protect against opening or breaking of the case.
- Incorporates SECO-LARM's patented yellow turbulence LED.

Protection Pattern:

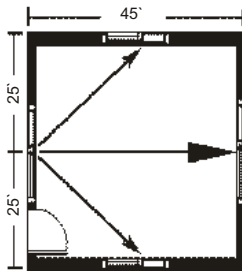

ON-BOARD INDICATOR LEDs MAKE THE DIFFERENCE
SECO-LARM's patented yellow turbulence LED reduces false alarms by offering easy pinpoint sensitivity adjustment without external test meters. The yellow LED flashes to indicate that the ambient environmental noise is too high, and may cause false alarms. This allows the installer to instantly change the sensitivity to fit the noise level at virtually any site. The red LED indicates an alarm condition. With the two LEDs, setting sensitivity is both simple and accurate.

Vibration Detector

SS-040Q Vibration Detector



SS 040Q/BR Shown

- Detects shocks to window glass, walls, ceilings, or CCTV enclosures. For N.C. circuits.
- Pure silver contact points.
- Built-in tamper switch for complete security.
- Adjustable contact pressure.
- Contact rating: 1A@50VDC.
- Small size: $\frac{5}{8}$ "x $\frac{7}{8}$ "x $2\frac{3}{8}$ " (16x22x60 mm).
- Operating temperature: -40°~167° F (-40°~75° C).
- **SS-040Q/W** — White enclosure.
- **SS-040Q/BR** — Brown enclosure.